

## PRODUCT OVERVIEW: MECFLOW PRESS

P1

MecFlow Press is a complete multi-layer composite pipe range, specifically engineered for potable, hot and cold plumbing and heating applications. The system is available in a range of diameters from Ø16mm to Ø50mm and is certified to EN ISO 21003 with WRAS approval.

### 16-32mm Fittings

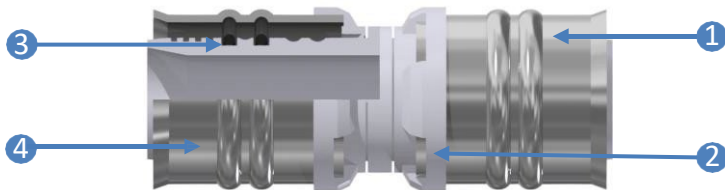

- 1 Stainless steel sleeve with tool guide
- 2 Inspection hole to easily ensure correct pipe insertion depth

### 40-50mm Fittings

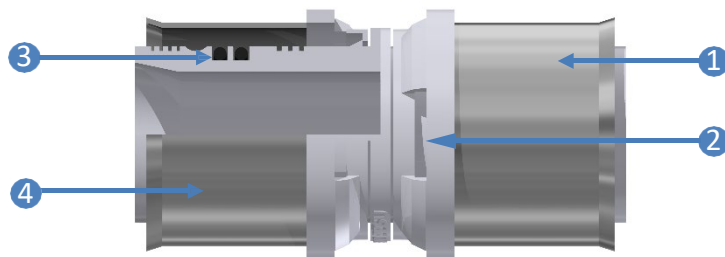

- 3 2 O-rings for permanently pressed sealing
- 4 Can be pressed using F & TH jaw (16-32 F and TH, 40-50 F only)

### 16-50mm Pipe

- A Polyethylene with raised temperature resistance (PE-RT)
- B Aluminium (Al)
- C Cross-linked polyethylene (PE-X)
- D Special composite adhesive binds each layer

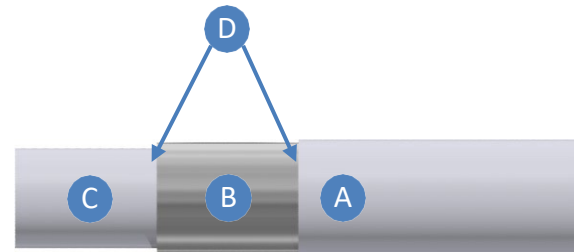

### System Features & Benefits

- Full range of press-fit fittings manufactured from PPSU, DZR lead-free brass and stainless steel
- Fittings with 30% larger cross-sectional surface area for greater flow rates
- Leak before press test for visual inspection from 1 to 6.5bar
- 16-32mm available in coils and straight lengths
- 40mm and 50mm available in straight lengths only
- Smooth bore limiting biofilm growth
- High durability and tensile strength
- Low thermal linear expansion



More detailed information about the MecFlow Press range is available in the Technical Manual. Please visit <http://www.polypipe.com/commercial-building-services/technical-hub/mecflow> to download your copy.

PDS-026\_Version 3\_Issued 26.08.2025