

- PERMEABLE BLOCK PAVING SYSTEM 80mm THICK
- BEDDING LAYER - TYPE 2/6.3 TO BS EN 13242:2002 50mm THICK
- POLYPIPE PERMAFILTER GEOTEXTILE
- MODIFIED SUB-BASE AS TYPE 4/20 AGGREGATE TO BS EN 13242:2002 OR SIMILAR TO ENGINEERS SPEC (thickness to suit application and CBR value)
- POLYPIPE HEAVY DUTY IMPERMEABLE GEOMEMBRANE
- POLYPIPE PERMAVOID 300 FLEECE
- PREPARED FORMATION (CAPPING IIF REQUIRED TO ENGINEERS SPEC.)

RAINWATER DOWNPIPE DRAINAGE INTO A SUB-BASE RESERVOIR
Scale (1:20)

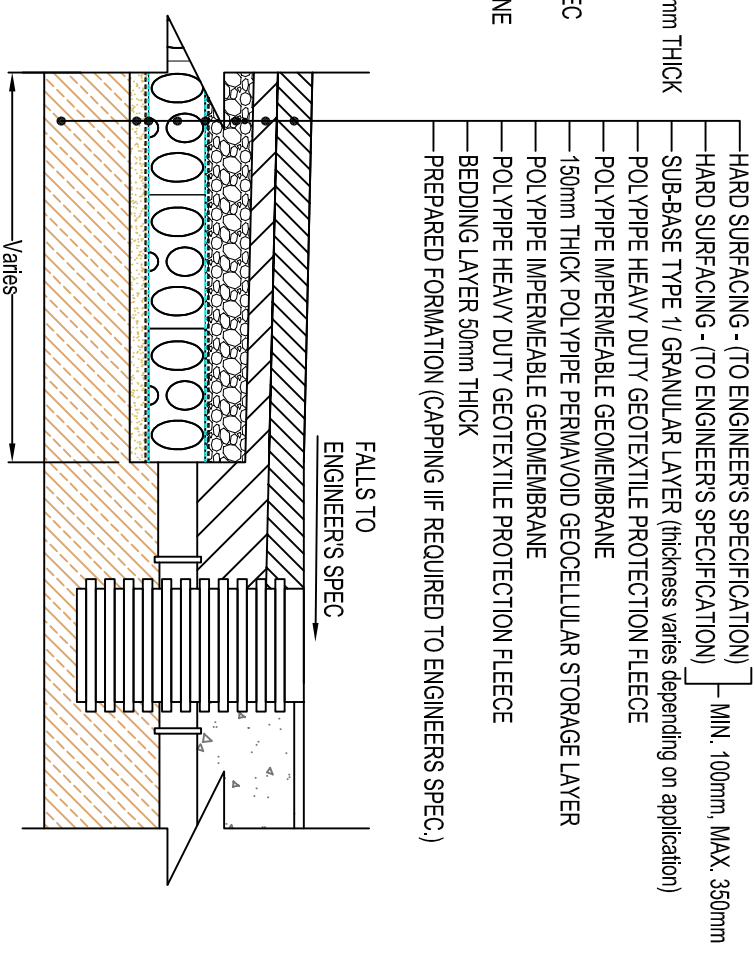

- HARD SURFACING - (TO ENGINEERS SPECIFICATION) — MIN. 100mm, MAX. 350mm
- SUB-BASE TYPE 1/1 GRANULAR LAYER (thickness varies depending on application)
- POLYPIPE HEAVY DUTY GEOTEXTILE PROTECTION FLEECE
- POLYPIPE IMPERMEABLE GEOMEMBRANE
- 150mm THICK POLYPIPE PERMAVOID GEOCELLULAR STORAGE LAYER
- POLYPIPE IMPERMEABLE GEOMEMBRANE
- POLYPIPE HEAVY DUTY GEOTEXTILE PROTECTION FLEECE
- BEDDING LAYER 50mm THICK
- PREPARED FORMATION (CAPPING IIF REQUIRED TO ENGINEERS SPEC.)

RAINWATER DOWNPIPE DRAINAGE INTO A PERMAVOID RAFT
Scale (1:20)

NOTES

1. All dimensions in millimetres, unless otherwise stated.
2. All dimensions are nominal and may vary within manufacturing tolerances.
3. All site temporary and enabling works by others.
4. Permavoid units to be installed in accordance with Polypipe Civils recommendations (refer to Polypipe technical guidance for further information); giving due consideration to the requirements of the organisation who will be taking ultimate ownership of the installation.
5. This drawing is intended for guidance only. Confirmation of the information contained within this document should be sought from the consulting engineers before final design or construction activities commence.

REV	AMENDMENT	DATE

PERMAVOID STANDARD DETAIL

FOR INFORMATION

PROJECT	PERMAVOID STANDARD DETAIL	
TITLE	PERMAVOID RAINWATER PIPE CONNECTION DETAIL	
DATE	27/10/15	DRAWN BY: BM
ORIGINAL SIZE	A3	SCALE: AS SHOWN
DRAWING No.	PV_SD_AT_MC_001	REV:



Polypipe Civils

Charmwood Business Park,
North Road, Loughborough,
Leicestershire, LE11 1LE

Tel: 01509 615100
Fax: 01509 615215
www.polypipe.com/civils
www.polypipe.com/wms

The information in this document is of an illustrative nature and is supplied by Polypipe Civils without charge. This document does not form the whole or any part of a contract or intended contract with the user. The information within this document should not be solely relied upon to determine the suitability or installation requirements of our products for a proposed application and expected site conditions; expert advice should be sought in this respect. Final determination of the suitability of any information or material for the use contemplated and the manner of use is the sole responsibility of the user and the user must assume all risk and liability in connection therewith. Further information with regard to liabilities may be found at www.polypipe.com/disclaimer.