

Terrain FUZE Stax - Access Pipe (Top Section)

P1

To be used as a top section where access is required. A two-part solution (when used with a bathroom, kitchen, utility section, or in a vent stack) designed to provide easy installation.

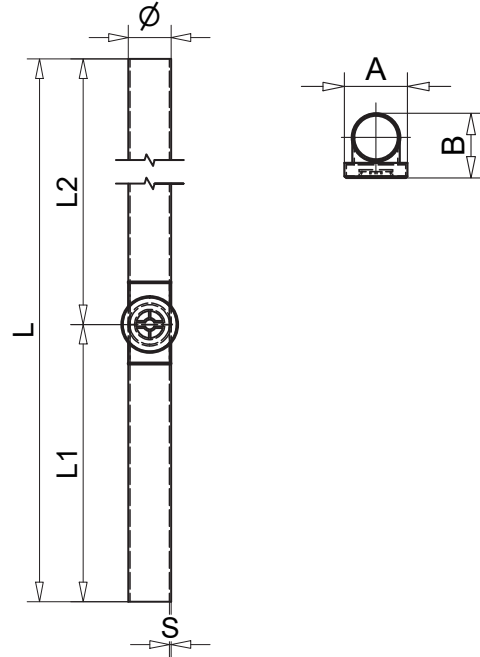

Product Code	ø (mm)	S (mm)	L (mm)	L1 (mm)	L2 (mm)	A (mm)	B (mm)
9412.56B	56	3	2344	881	1463	82	108
9412.75B	75	3.5	2344	881	1463	85	126
9412.110B	110	4.3	2023	648	1375	146	150
9412.160B	160	6.2	2023	648	1375	191	233

Features & Benefits

- UK manufactured
- Four options of diameter - 56, 75, 110 & 160mm
- Impact resistant
- Abrasion resistant
- Chemical resistant

PDS-020
Version: 1
Issued: 12/01/2023